

## Unboxing

Upon receiving your order, open the crate and inspect the contents. Damages must be reported within 24 hours.

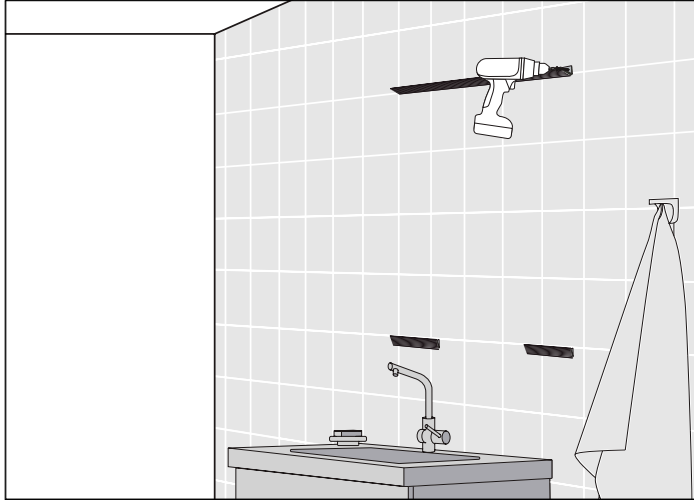

**1 Attach the Brackets to the Wall**  
Screw the mounts to the wall.

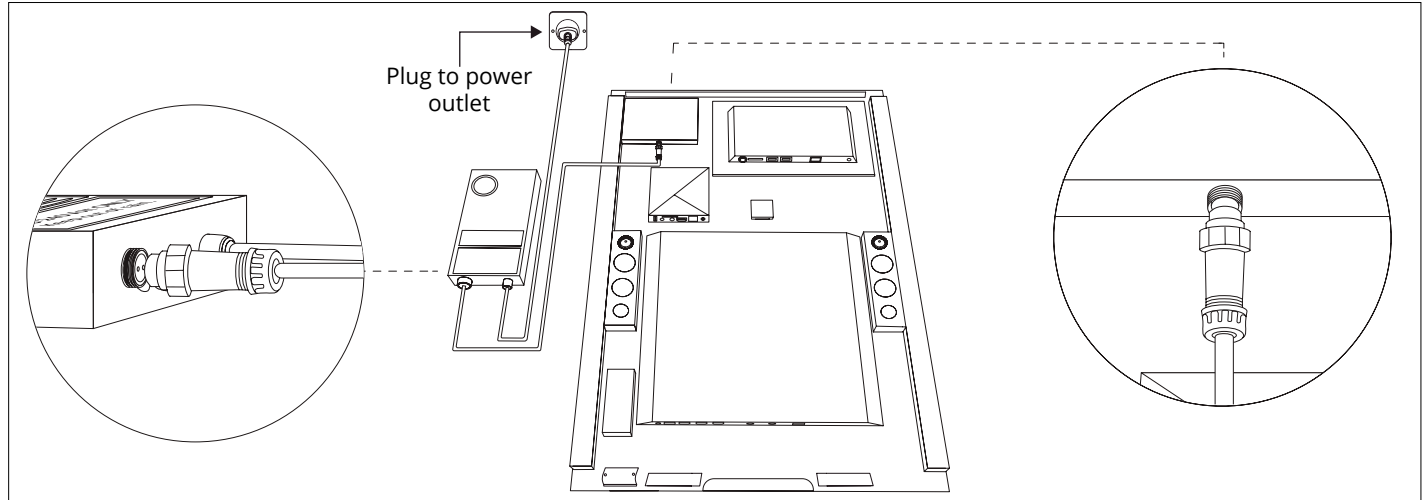

**2 Plug to a Power Source**  
Connect the mirror to a power source.

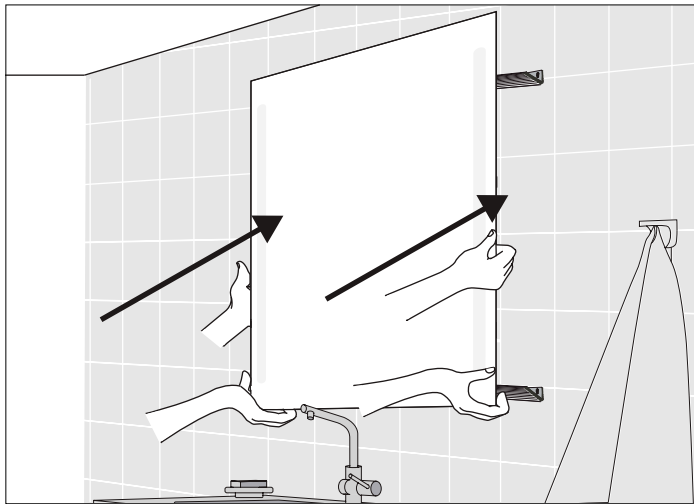

**3 Hang the Mirror**  
Hang the mirror to the wall mounts you installed on the wall.

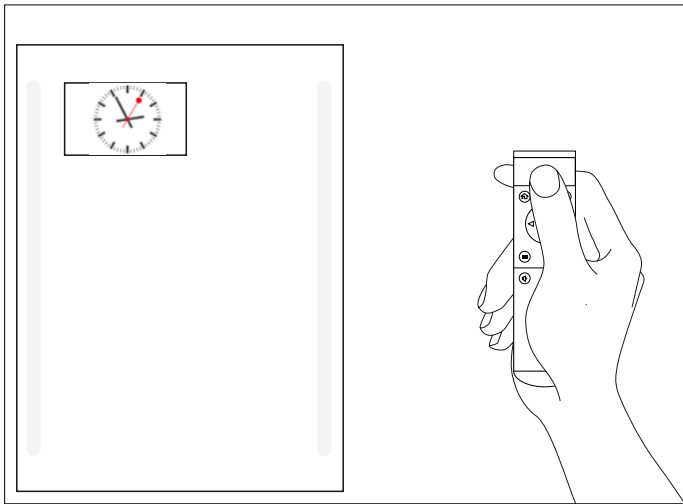

**4 Turn on the 12.1 Inch Panel**  
Turn the 12.1 inch panel on by pressing the power button on the smart remote control

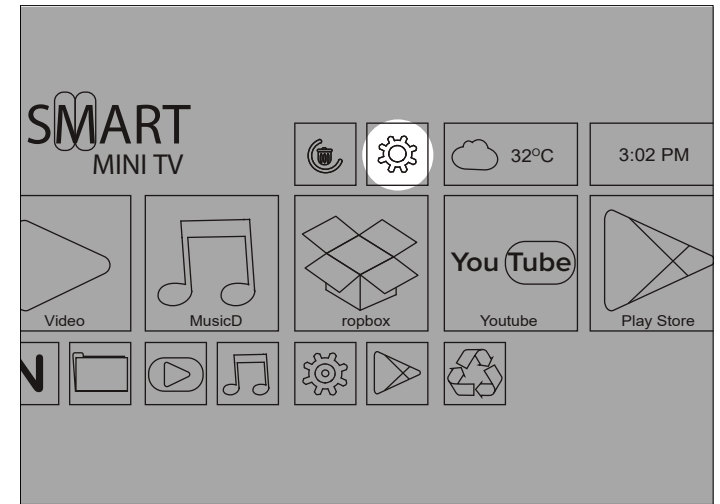

**5 Connect to the Internet**  
Once the screen is on. Click on the icon that looks like a gear. This will open up the settings menu where you can connect to the internet.

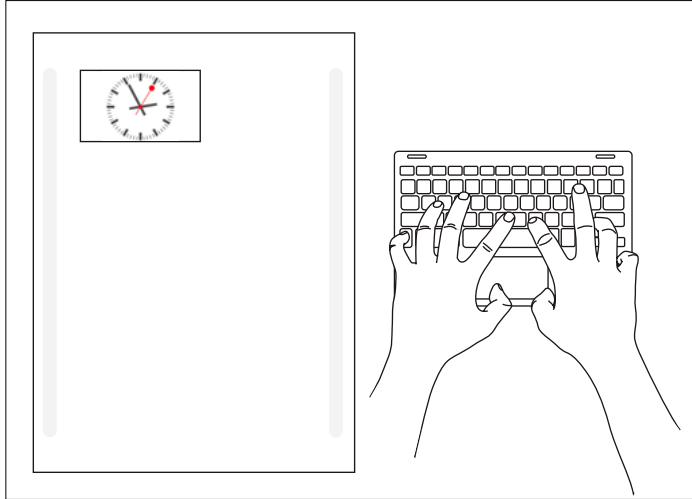

**6 Manage and Personalize**  
Use the keyboard to install and control smart apps.

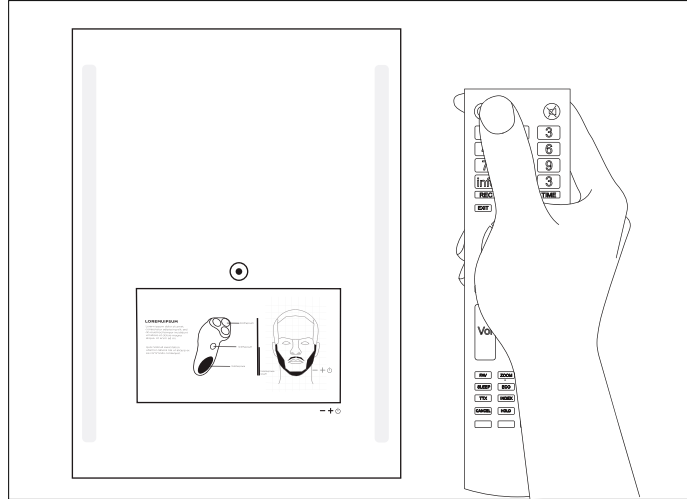

**7 Turn on the TV**  
Turn on the the Smart TV by pressing the power button located on the top left portion of the Evervue Remote.

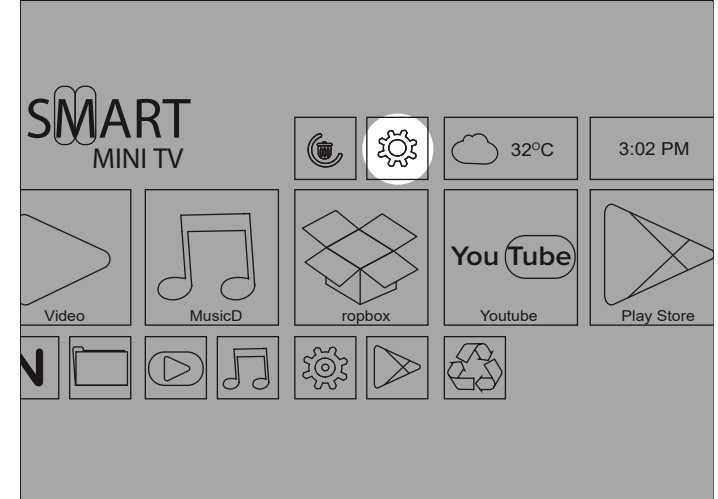

**8 Connect to the Internet**  
Again, find the gear icon and connect to the internet.

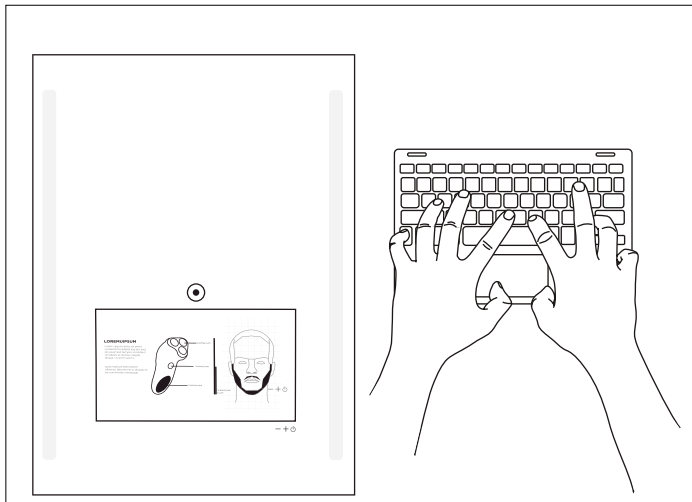

**9 Manage and Personalize**  
Use the keyboard to install and control smart apps. The Smart TV is also touch screen.

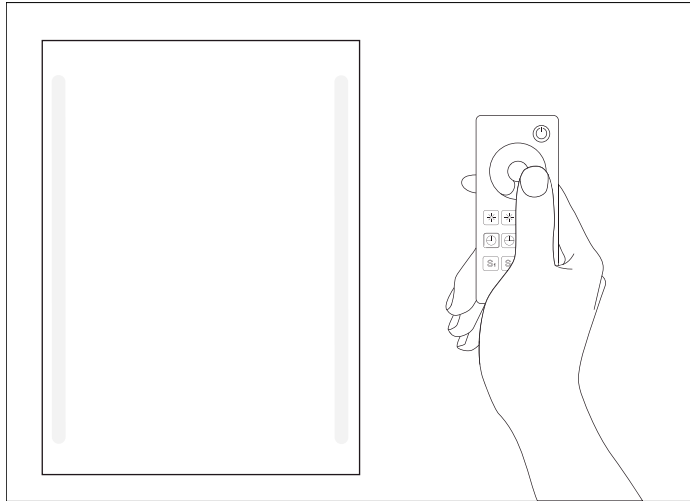

## Option 1

The mirror lights can be controlled using the RM100 remote control included in the box.

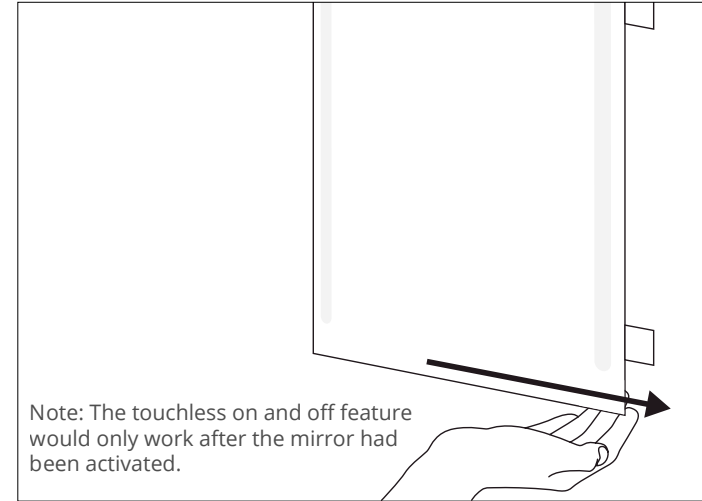

## Option 2

The mirror also has a touchless on and off feature. Simply wave your hand under the bottom right side of the mirror to turn the lights on and off.

# Qaio Mirror - How To Install Apps

Option 1: Download the APK Online



## 1 Download the APK

Download the APK online.

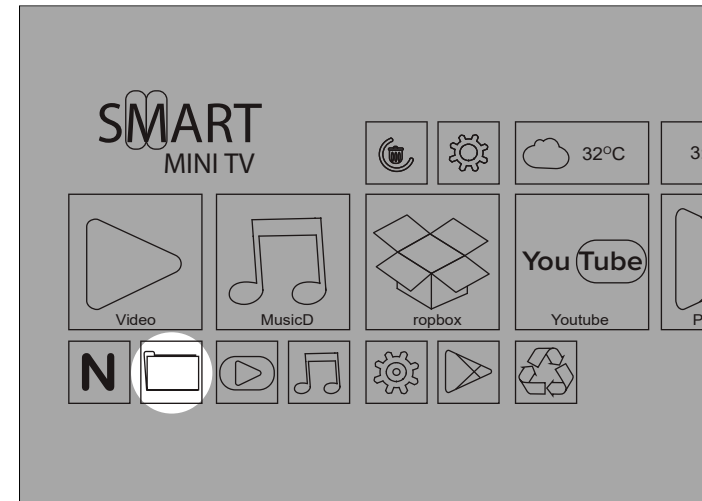

## 2 Install the App

Once the download is complete, Go to "File Manager" and find the APK you downloaded. Click it and it will be installed.

# Qaio Mirror - How to Install Apps

Option 2: Download from the Google Play Store

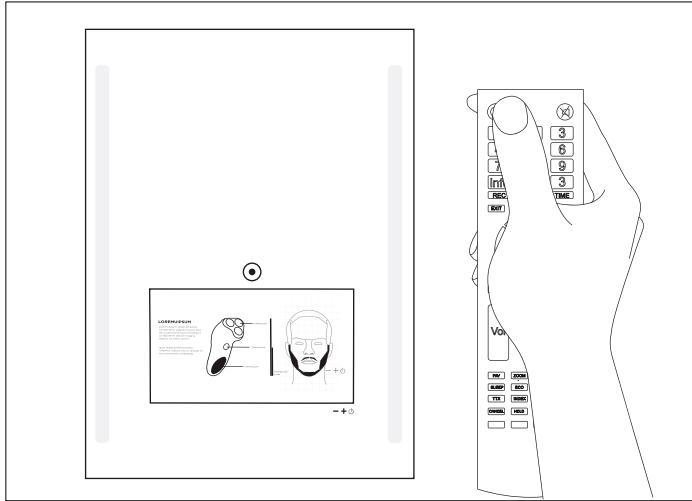

## 1 Turn on the TV

Turn on the the Smart TV by pressing the power button located on the top left portion of the Evervue Remote.

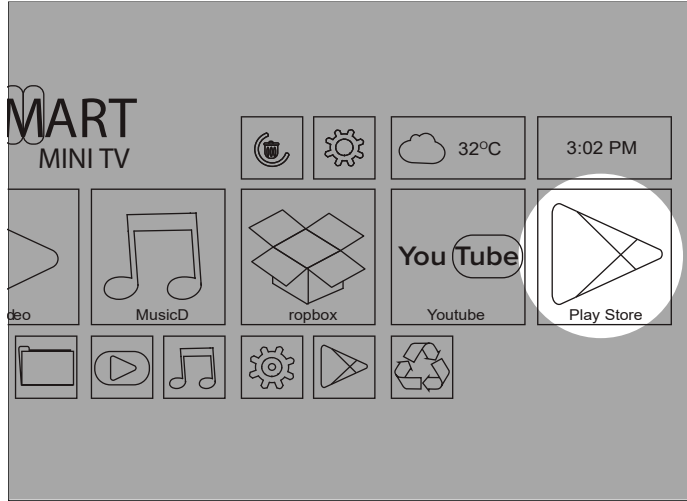

## 2 Click the Play Store icon

Go to Play Store.

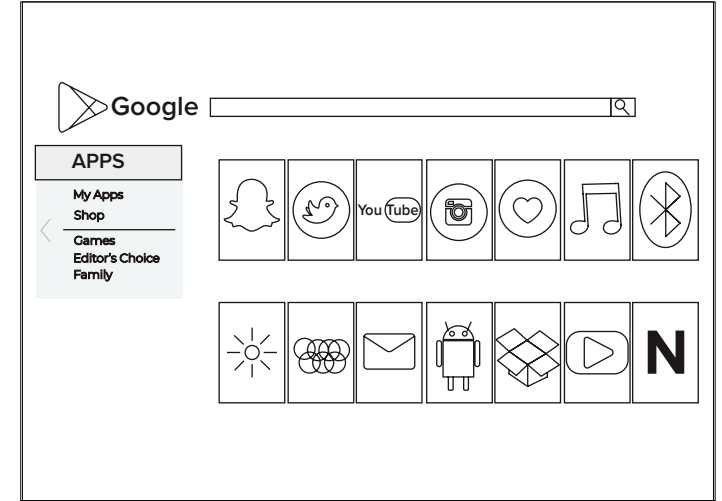

## 3 Browse

Find the app that you want and download it.

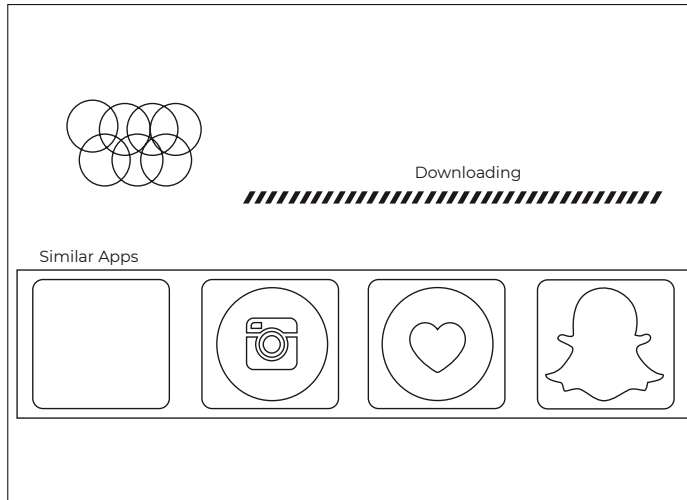

## 4 Install

Click install and wait for it to finish downloading.