

CINEMA

— Smart TV —



CINEMA TV PRODUCT MANUAL

Unboxing the Cosmos | Page 2
Cosmos Back View | Page 3
Cosmos Front View | Page 4
Cosmos Zepp Remote | Page 5
Cosmos Android Box | Page 6

Evervue Standard Remote | Page 7
Initial Set up | Page 8
Installing apps | Page 8
Care and Cleaning | Page 9



**Evervue Standard
TV Remote**
(RMS50)



Zepp Remote
(RM-ZEPP-BLACK)

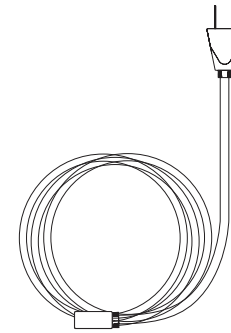

Power Cable
(3 meters)



Cinema TV

Upon receiving your order open the crate and inspect the content. Damages must be reported within 24 hours.

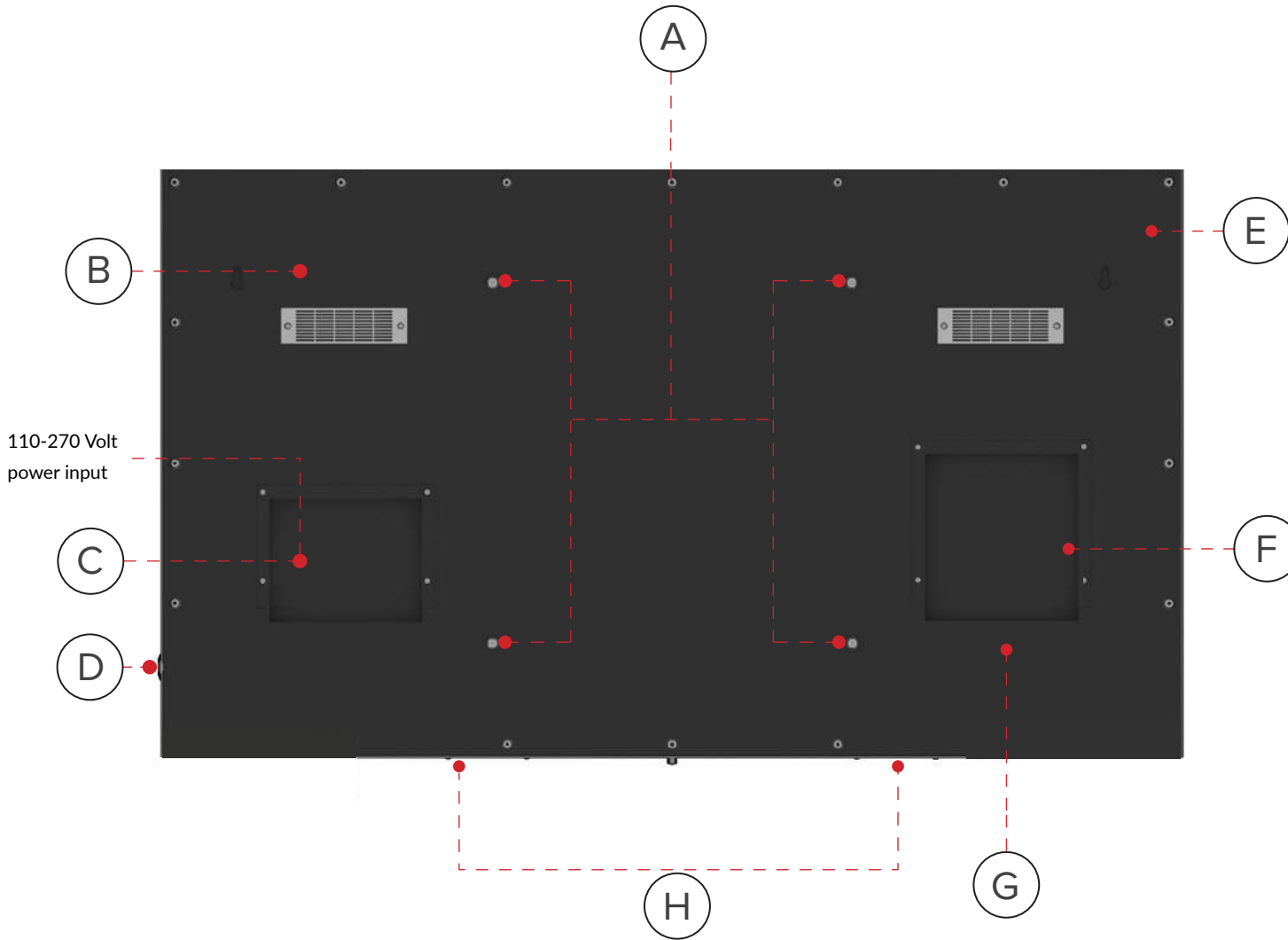

PARTS _____

- (A)** VESA Compatible for Mounts/Brackets
- (B)** Warm Air Outlet for Cooling System
- (C)** Power, HDMI, USB, Audio Compartment
- (D)** Stainless Steel, Easy Access On/Off Button
- (E)** Direct Wall Mount Openings
- (F)** Set Top Box Compartment
- (G)** Kensington Lock Opening
- (H)** Cool Air Inlet

PARTS _____

I Extra thin Bezel

J Wide Andle Infrared Receiver

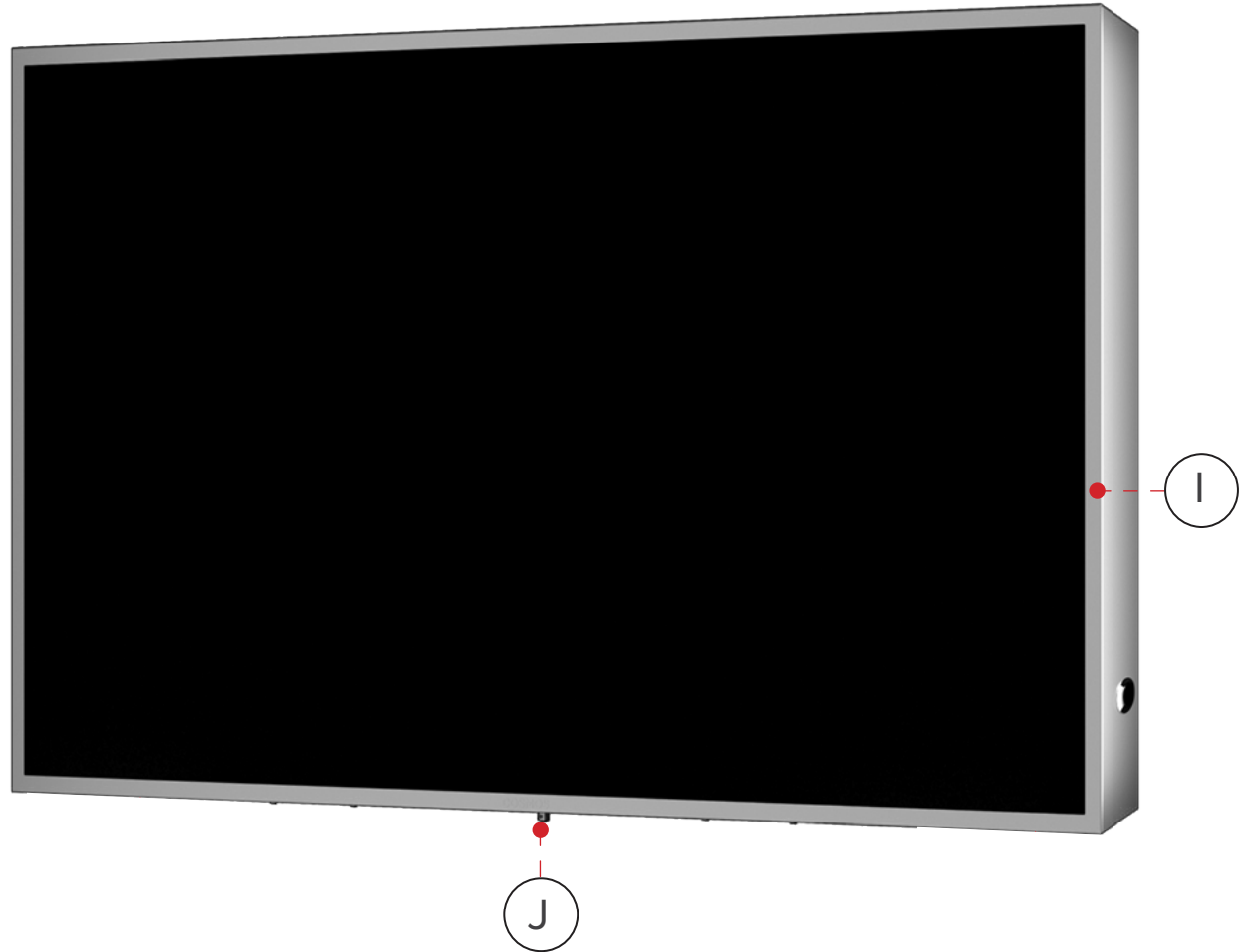

ZEPP REMOTE (RM-ZEPP-BLACK)

BUTTONS



- A **Mic/Mouse**
- B **Volume Down**
- C **Volume Up**
- D **Navigation Keys**
- E **Enter**
- F **Return**
- G **Menu**
- H **Home**

HOW TO INSTALL THE GOOGLE ASSISTANT

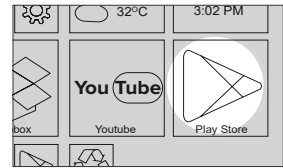

1 Open the play store and search for Google.

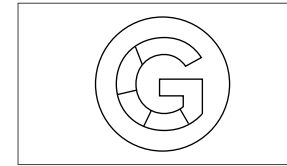

2 Download Google. Then tap the icon on the home screen.



3 Control the app with either your voice or the keyboard on the remote.

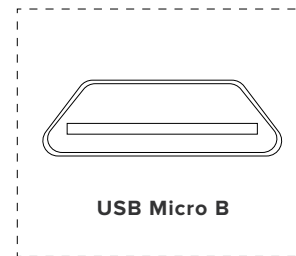

USB Micro B

NOTES

- The Zepp Remote is rechargeable. It can be charged using the USB Micro B port in one of its edges.
- When using the mic/mouse button, keep pressing the button while speaking and only let go once you are done.

(Configuration depending on market)

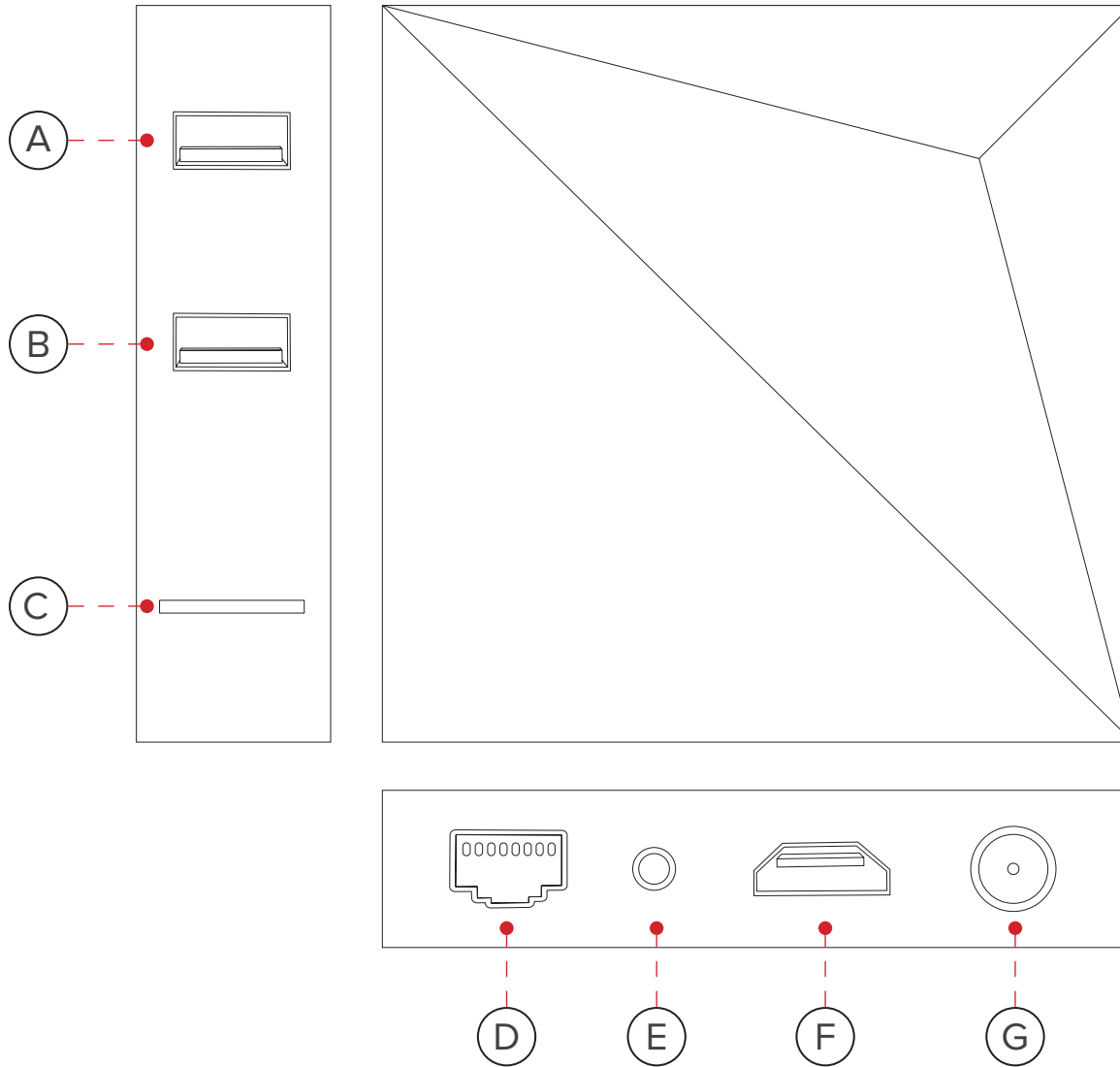

BUTTONS

- A** USB Port
- B** USB Port
- C** Micro SD Card
- D** Ethernet Cable
- E** Audio Port
- F** HDMI Port
- G** Power Port

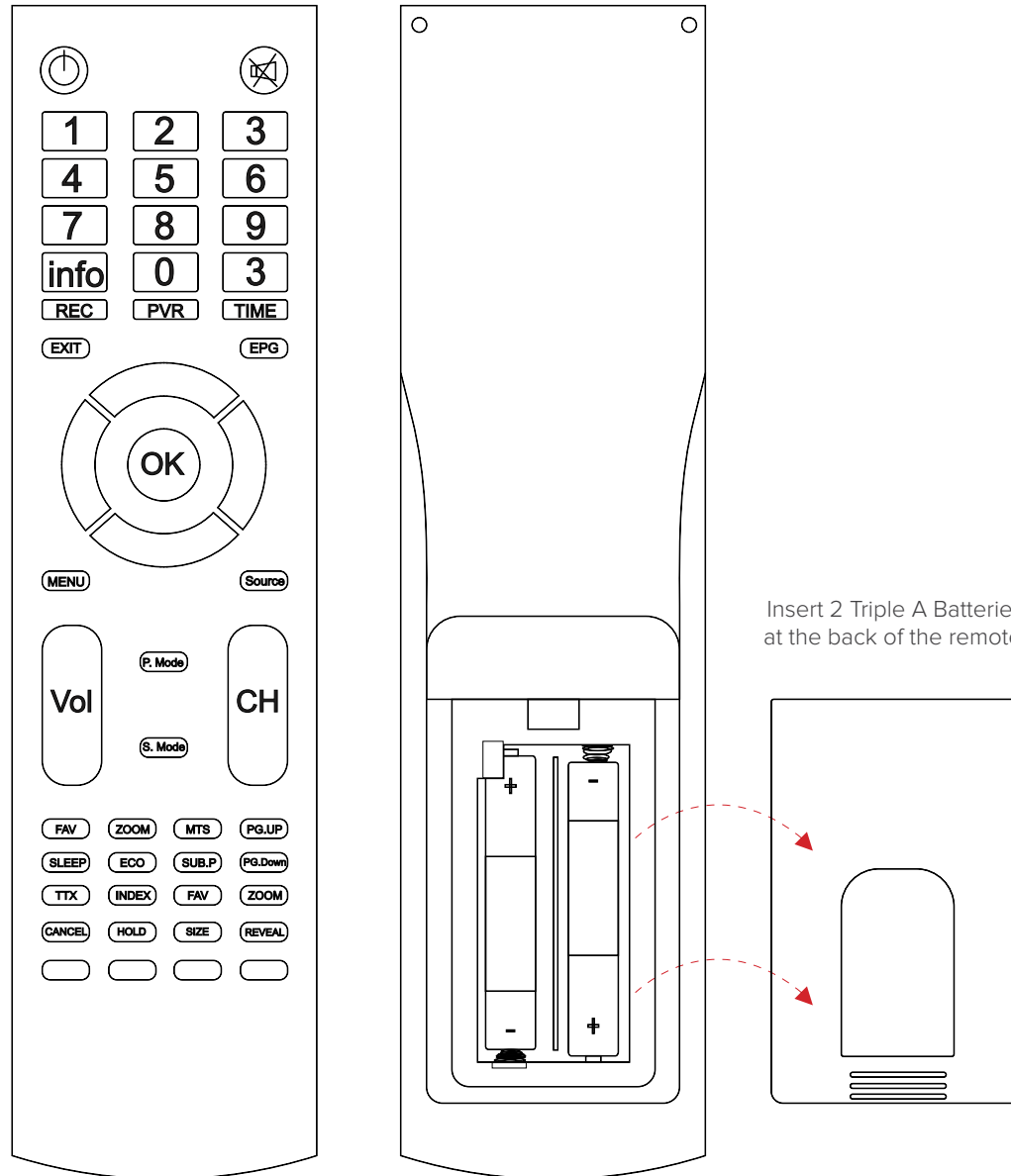

WHAT CAN YOU DO WITH THIS REMOTE?

- Change the brightness and color of the screen.
- Change the HDMI input
- Increase the audio volume of the TV.
- several more advanced settings

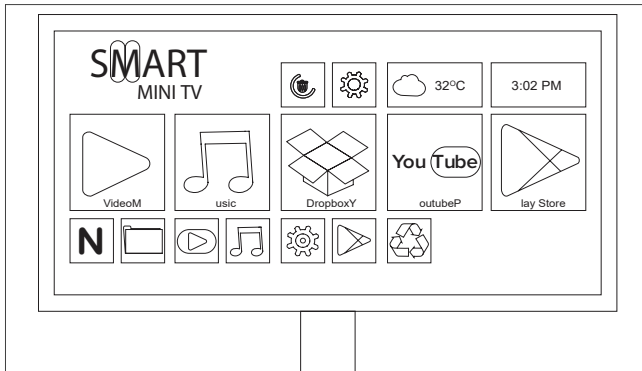

1 Turn on Cinema TV

Either Press the power button on the right side of the T.V. or on the remote to turn the cosmos on.

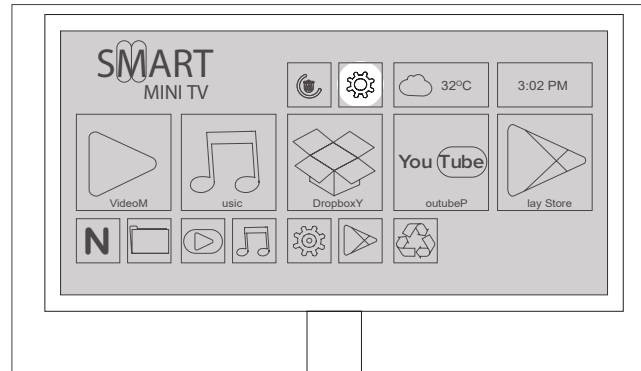

2 Connect to the internet

Go to "Settings" and choose "network".

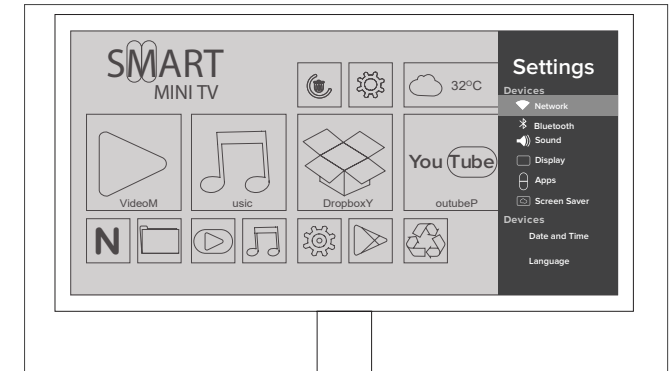

3 Connect to the internet

Find your wi-fi name on the list of networks that would pop up and enter your password.

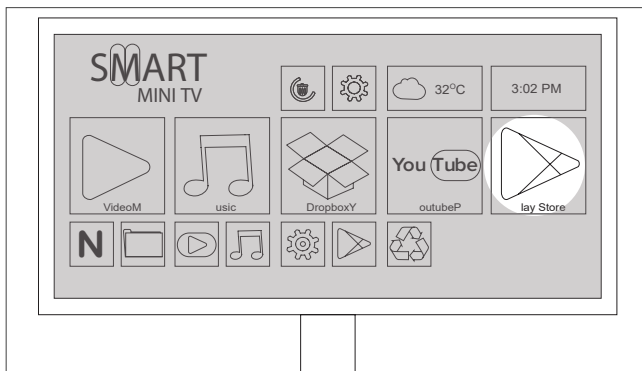

Option 1 Google Play Store

Find the desired app on the Google Play Store. Download and install it on your device.

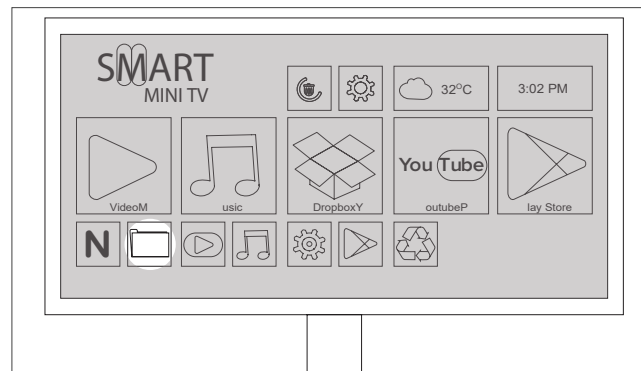

Option 2 Install APK

Download your APK online. Find it on the "File Manager" and double click it to install.

ONLY APPLICABLE FOR THE BRUSHED STAINLESS STEEL

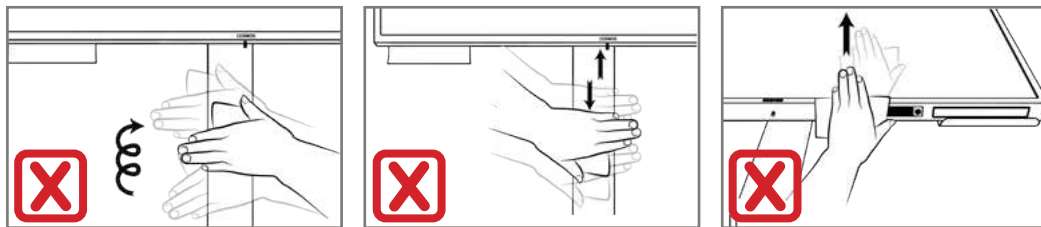
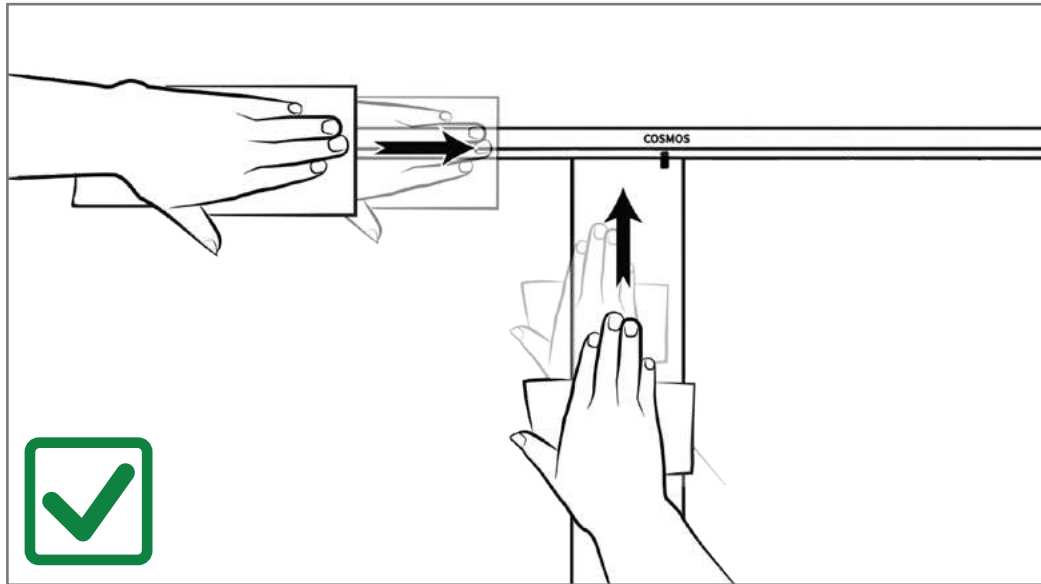

With this special buffer you make stainless steel look as new again in minutes.

Important Notes:

1. Please press firmly with buffer in one sweeping motion in the same direction as the structure and grain of the stainless steel.
2. DO NOT make circular movements.
3. DO NOT go against the grain and structure of the stainless steel.

So entferne man wirkungsvoll kleinere Kratzer aus dem Edelstahlrahmen. Mit dem in der Lieferung enthaltenem Pflegeschwamm können gegebenenfalls kleinere

Bitte beachten:

1. Immer und ausschließlich in gleichmäßig fortlaufender Richtung mit konstantem Druck der Struktur des Stahls folgen.
2. Niemals versuchen in wechselnden Richtungen von links nach rechts, oben nach unten oder in kreisenden Bewegungen die Stahlfläche zu bearbeiten. Nur wenn Sie die Anweisung (wie in Position Nummer 1. beschrieben) strikt befolgen, werden Sie ein sichtlich zufriedenstellendes Resultat erzielen.

Avec ce tampon spécial, donnez un nouveau look à votre cadre en acier inoxydable en quelques minutes.

Important:

1. Appuyez fermement avec le tampon avec un mouvement rectiligne dans la même direction que les lignes de structure de l'acier inoxydable.
2. NE PAS faire de mouvements circulaires.
3. NE PAS aller à l'encontre des lignes de structure de l'acier inoxydable.

Volg de onderstaande instructies en uw RVS is weer in enkele minuten als nieuw.

Belangrijk:

1. Wrijf stevig en met één beweging in de richting van de structuur van het RVS.
2. Maak geen cirkelvormige bewegingen. Wrijf niet tegen de structuur richting in.

使用这种特殊的百洁布会让您的不锈钢立即焕然一新。

重要信息:

1. 请顺着不锈钢本身的结构与纹理单向紧按百洁布进行擦拭（不可交叉擦拭）。
2. 请勿以打圈方式擦拭。