

PARTS

Text

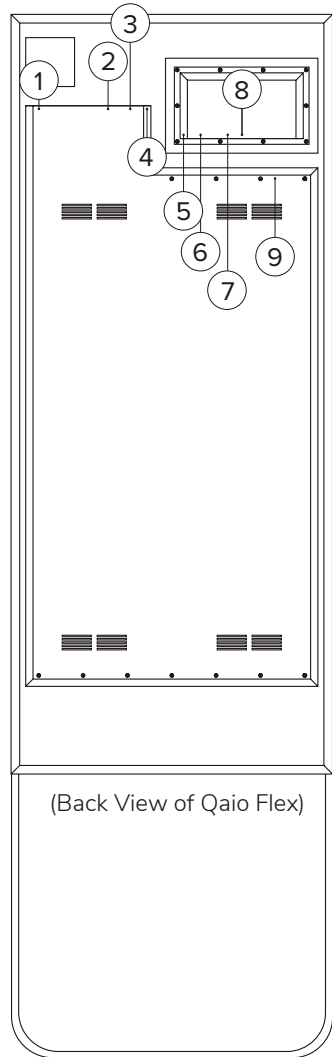

- ① Power Input
- ② HDMI
- ③ USB
- ④ Output 12v
- ⑤ Power Input
- ⑥ SD
- ⑦ USB
- ⑧ LAN
- ⑨ Output 12v

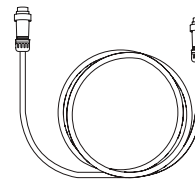

Extension Cord

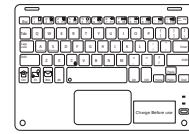

Keyboard and charger



Smart Remote Control

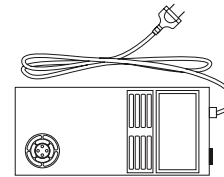

Power Supply



Evervue Remote

1 Upon receiving your order, open the crate and inspect the content. Damages must be reported within 24 hours.

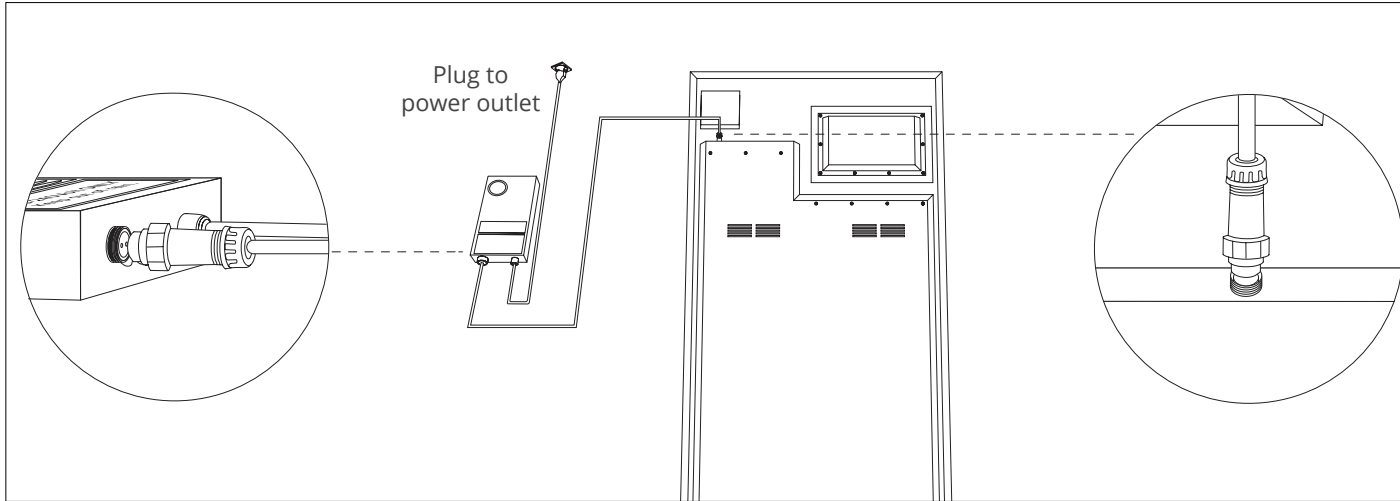

2 Connect the mirror to the power supply.

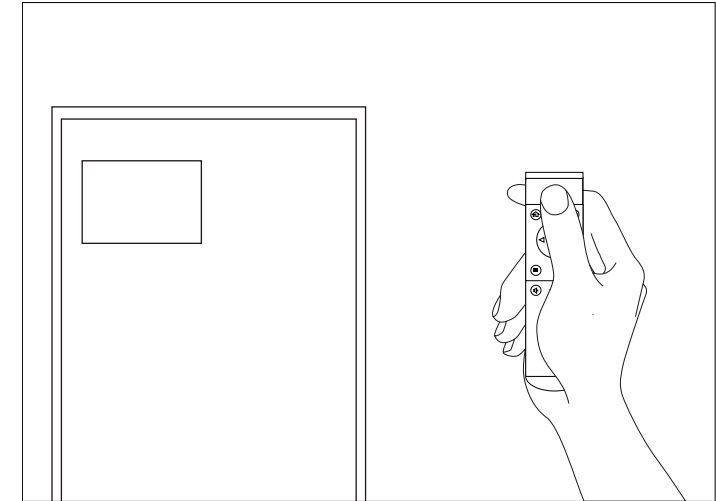

3 Turn on the the 12.1 inch panel by pressing the power button on the smart TV remote.

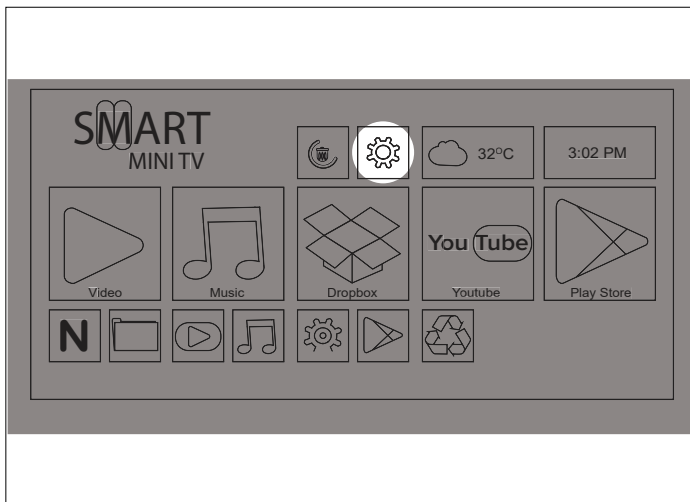

4 Turn on the the 12.1 inch panel by pressing the power button on the smart TV remote.

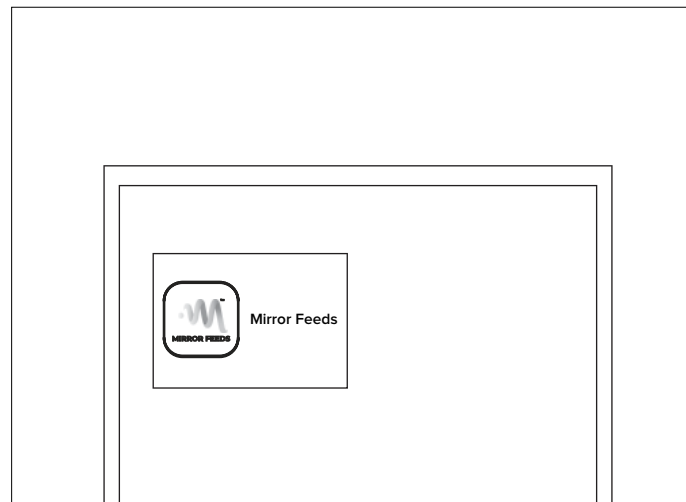

5 Go to the QAIO website, download the mirror feeds app, and install it on your mirror. For a more in-depth guide please see the mirrorfeeds manual on the Help center of the QAIO website.

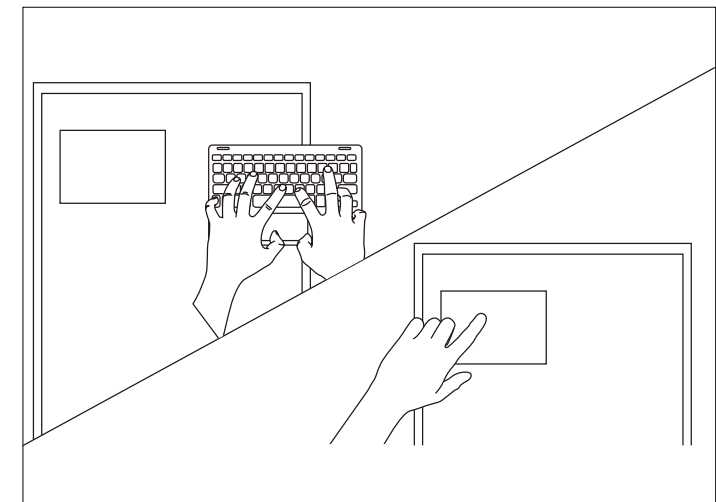

6 Navigate with the wireless keyboard or directly on the mirror to download and manage apps.

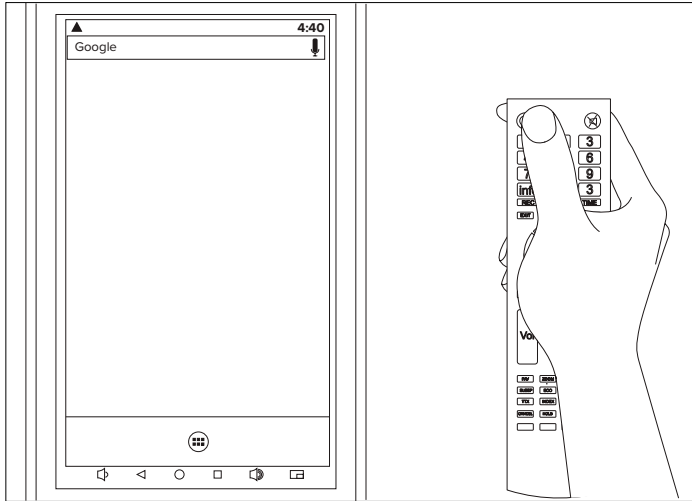

7 Turn on the Smart TV by pressing the power button on the TV remote.

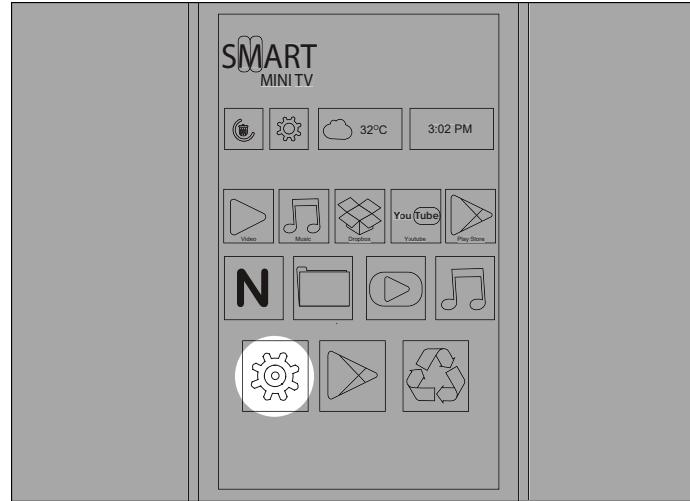

8 Go to settings and connect to the internet.

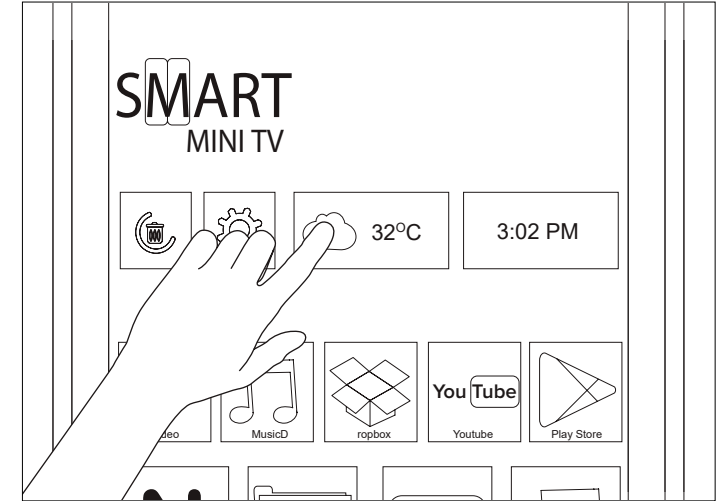

9 Manage and control the mirror directly with its touch screen feature.

QAIO Flex (Lean On Mount) Application Setup

OPTION 1: Download the application from the Play Store.

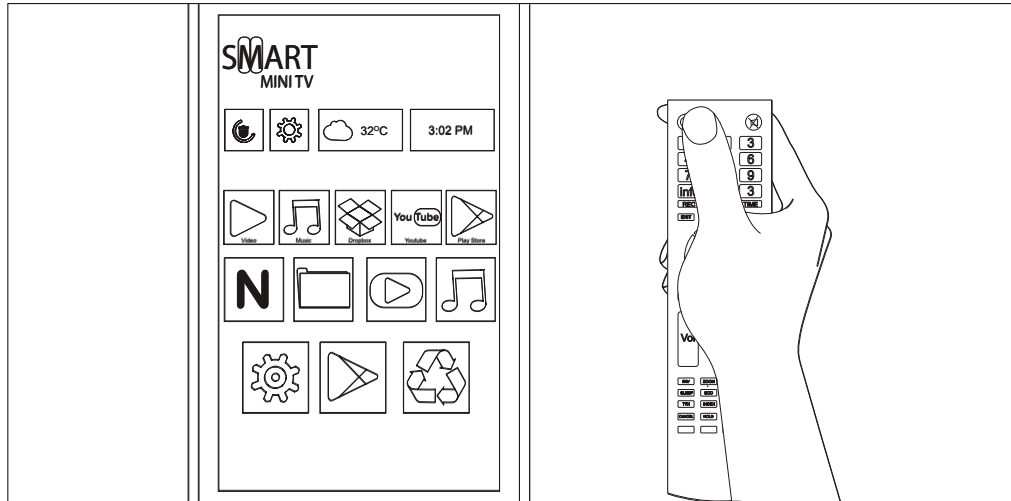

1 Turn the Smart TV on by pressing the power button on the TV remote.



2 Go to Play Store.

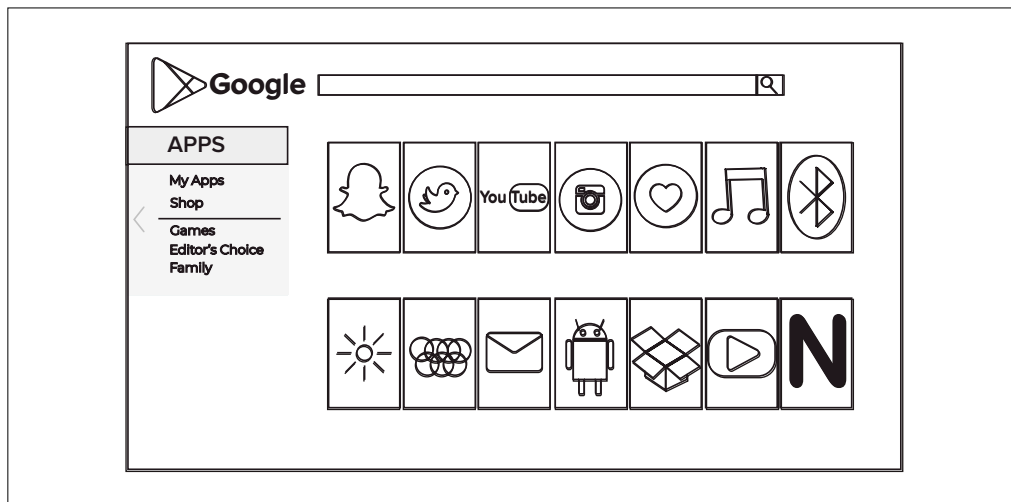

3 Search for the app you wish to install.

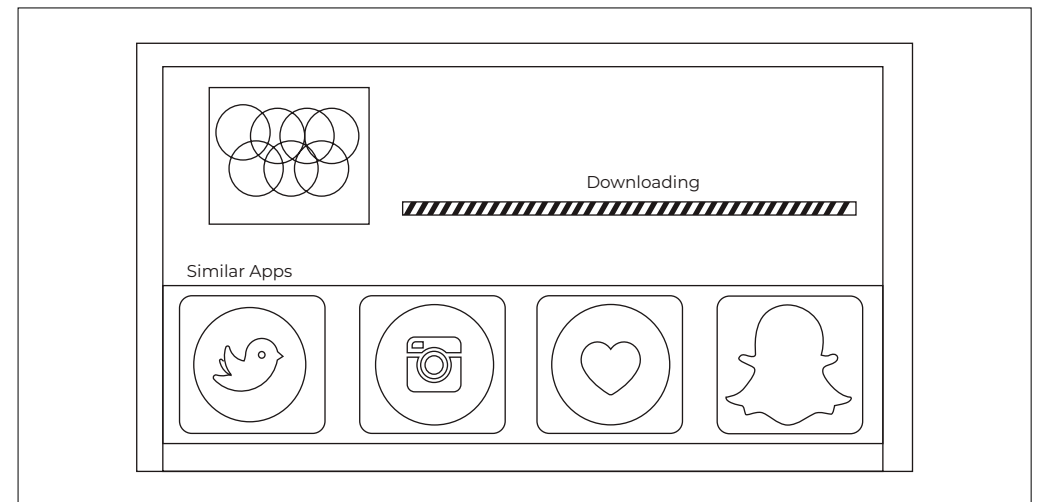

4 Click install and wait for it to finish downloading.

OPTION 1: Download and install APK of the application.

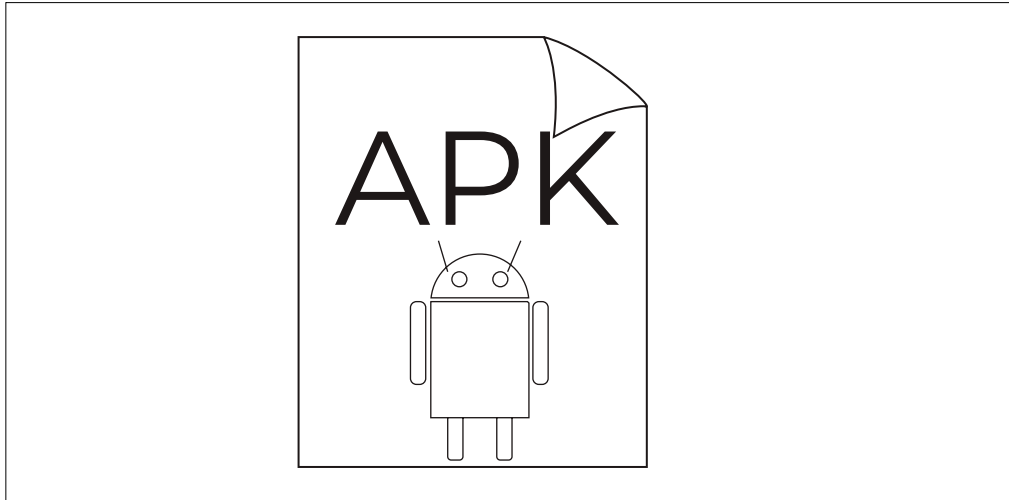

1 Find and download the APK of your desired application online.



2 Once the download is complete. Go to file manager and find the APK you downloaded. Click it and it will be installed.